

www.wackergroup.com

0154582en	001
0602	

Vibroplate

WP 1550A

WP 1550AW

OPERATOR'S MANUAL



0 1 5 4 5 8 2 E N

BELGIE

1730 ASSE-MOLLEM
4040 Herstal
9800 Deinze
B - 6041 Gosseles

ASSESTEENWEG 17
4 Avenue
Kortrijkse Steenweg 400
Rue Adrienne Bolland s/n

Tel. (32) 02-4528509+07
Tel. (09)-386 8529
Tel. 071-372450

ČESKÁ REPUBLIKA

19402 PRAHA 9-HLOUBETIN

KOLBENOVA 259

Tel. (0042) 2 862165

DANMARK

2690 KARLSLUNDE
8200 Arhus N
5250 Odense SV

RØRGANGEN 6
Randersvej 346
Holkebjergvej 56A

Tel. 46 15 36 00
Tel. 86-231777
Tel. 66-172170

ESPAÑA

28850 TORREJON DE ARDOZ (MADRID)

08780 PALLEJA (Barcelona)
41700 Dos Hermanas (Sevilla)

46133 Meliana (Valencia)
15890 Santiago de Compostela (La Coruña)

POLIGONO INDUSTRIAL LAS MONJAS
CALLE PRIMAVERA 11
PRAT DE LA RIBA, 184
Poligono Industrial La Palmera
Nave 14
Calle Salvador Giner, 6
Poligono Industrial el Tambre, Via Pasteur, 47a

Tel. (34) 91-6757525 / 85
Tel. (93)-6632273
Tel. (95)-4691129
Tel. (95)-4691129
Tel. (96)-1492102
Tel. (981) 573366 / 67

SUOMI

FIN 04250 KERAVALA

Peltomäenkatu 7

Tel. (358) 9-274 4740

FRANCE

77170 BRIE COMTE ROBERT
Aix en Provence
Arras
Bordeaux
Bourges
Lyon
Nancy
Rennes
Toulouse
Kehl

335, RUE GLORINETTE—ZAC DU TUBOEUF
13540 Puyricard
62217 Beaurains
33700 Merignac
18390 St. Germain du Puy
69740 Genas
54180 Heillecourt
35510 Cesson Sevigne
31270 Cugnaux
77694 Kehl-Goldscheuer

Tel. (33) 1-60623000
Tel. 4 42630526
Tel. 3 21235361
Tel. 5 56343346
Tel. 2 48652015
Tel. 4 78401384
Tel. 3 83565801
Tel. 2 99321522
Tel. 5 61075250
Tel. (0590) 9321

HUNGARIA

1106 BUDAPEST

Kada u. 137

Tel. (36) 1-260 8668

IRELAND

DUBLIN 13

127A. BALDOYLE INDUSTRIAL ESTATE

Tel. (00353) 01-8320218

ITALIA

40016 SAN GIORGIO DI PIANO (Bologna)
00125 ACILIA (Roma)
20041 Agrate Brianza (Mi)

Via Due Agosto, 1980, Strage di Bologna, 3
Viale Enrico Ortolani, 262
Via Archimede, 31

Tel. 39.05.665.566 - 665.1574
Tel. 39 . 06 . 5219246
Tel. 39. 039.699 0136

NEDERLAND

3821 BJ AMERSFOORT
2984 BL Ridderkerk
7418 EZ Deventer
5684 PS Best
1704 RT Heerhugowaard
9411 XN Beilen

COBOLWEG 1
Glasblazerstraat 7
Arnbergstraat 9
De Dintel 37
Einsteinstraat 4d
De Hanekampen 19

Tel. 033 - 450 40 45
Tel. 0180 - 41 70 56
Tel. 0570 - 63 00 87
Tel. 0499 - 33 04 33
Tel. 072 - 574 20 78
Tel. 0593 - 52 31 24

NORGE

1481 HAGAN

TYRIVN. 7

Tel. (47) 0 6707-2330

POLSKA

05-850 OŻARÓW MAZOWIECKI
62-081 Wysogotowo k. Poznania

UL. KONOTOPSKA 4
ul. Kamienna 1

Tel. (48) 22 722 20 59
Tel. (061) 814-3797

PORTUGAL

2785-S. Domingos De Rana
4785-S. Romao do Coronado

Urbanização Industrial de Trajouce, Lote 1
Lg. do Soeiro, Apartado 2

Tel. (351) 21 4443561 / 87
Tel. (351) 22 982 7992 / 93

SVERIGE

24734 SÖDRA SANDBY
16170 Bromma
41749 Göteborg

SKATTEBERGAVÄGEN 13
Karlsbodavägen 17E
Knipplekullen 3A

Tel. (46) 046-57870
Tel. 08-282860
Tel. 031-551362

SCHWEIZ

8305 Dietlikon

Bahnhofstrasse 3

Tel. (41) 1-8353939

TÜRKIYE

81120 K. Bakkalköy-İSTANBUL
35350 Üçkuyular-İzmir
Ostim 06370 Ankara

Karaman Çiftliği Cad. No: 55
Mithatpaşa Cad. No. 1189
Aliinteri Bulvarı No. 210

Tel. (90) 216 573 0621
Tel. (90) 232 259 8944
Tel. (90) 312 385 6438/6439

1. Foreword	3
2. Safety Information	4
2.1 Laws Pertaining to Spark Arresters	4
2.2 Operating Safety	5
2.3 Operator Safety while using Internal Combustion Engines	6
2.4 Service Safety	7
2.5 Label Locations	8
2.6 Warning and Informational Labels	9
2.7 Operating Labels	12
3. Technical Data	14
3.1 Engine Data - Honda	14
3.2 Plate Data	15
3.3 Sound and Vibration Specifications	15
3.4 Dimensions	16
4. Operation	17
4.1 Recommended Fuel	17
4.2 Before Starting	17
4.3 To Start	17
4.4 To Stop	18
4.5 Application	18
4.6 Operation	19

5.	Maintenance	20
5.1	Periodic Maintenance Schedule	20
5.2	Cleaning Plate	20
5.3	Drive Belt	21
5.4	Exciter Lubrication	22
5.5	Spark Plug	23
5.6	Engine Oil	24
5.7	Air Cleaner	25
5.8	Cleaning Sediment Cup	26
5.9	Carburetor Adjustment - Honda	27
5.10	Troubleshooting	28
5.11	Storage	28
5.12	Lifting Machine	29
5.13	Transporting Machine	30



Engine exhaust, some of its constituents, and certain vehicle components contain or emit chemicals known to the State of California to cause cancer and birth defects or other reproductive harm.

1. Foreword

This manual provides information and procedures to safely operate and maintain this Wacker model. For your own safety and protection from injury, carefully read, understand and observe the safety instructions described in this manual.

Keep this manual or a copy of it with the machine. If you lose this manual or need an additional copy, please contact Wacker Corporation. This machine is built with user safety in mind; however, it can present hazards if improperly operated and serviced. Follow operating instructions carefully! If you have questions about operating or servicing this equipment, please contact Wacker Corporation.

The information contained in this manual was based on machines in production at the time of publication. Wacker Corporation reserves the right to change any portion of this information without notice.

All rights, especially copying and distribution rights are reserved.

Copyright 2002 by Wacker Corporation.

No part of this publication may be reproduced in any form or by any means, electronic or mechanical, including photocopying, without express written permission from Wacker Corporation.

Any type of reproduction or distribution not authorized by Wacker Corporation represents an infringement of valid copyrights and will be prosecuted. We expressly reserve the right to make technical modifications, even without due notice, which aim at improving our machines or their safety standards.

2. Safety Information

This manual contains DANGER, WARNING, CAUTION, and NOTE callouts which must be followed to reduce the possibility of personal injury, damage to the equipment, or improper service.



This is the safety alert symbol. It is used to alert you to potential personal injury hazards. Obey all safety messages that follow this symbol to avoid possible injury or death.



DANGER

DANGER indicates an imminently hazardous situation which, if not avoided, will result in death or serious injury.



WARNING

WARNING indicates a potentially hazardous situation which, if not avoided, could result in death or serious injury.



CAUTION

CAUTION indicates a potentially hazardous situation which, if not avoided, may result in minor or moderate injury.

CAUTION: Used without the safety alert symbol, CAUTION indicates a potentially hazardous situation which, if not avoided, may result in property damage.

Note: *Contains additional information important to a procedure.*

2.1 Laws Pertaining to Spark Arresters

Notice: State Health Safety Codes and Public Resources Codes specify that in certain locations spark arresters be used on internal combustion engines that use hydrocarbon fuels. A spark arrester is a device designed to prevent accidental discharge of sparks or flames from the engine exhaust. Spark arresters are qualified and rated by the United States Forest Service for this purpose.

In order to comply with local laws regarding spark arresters, consult the engine distributor or the local Health and Safety Administrator.

2.2 Operating Safety

**WARNING**

Familiarity and proper training are required for the safe operation of equipment! Equipment operated improperly or by untrained personnel can be dangerous! Read the operating instructions contained in both this manual and the engine manual and familiarize yourself with the location and proper use of all controls. Inexperienced operators should receive instruction from someone familiar with the equipment before being allowed to operate the machine.

- 2.2.1 NEVER allow anyone to operate this equipment without proper training. People operating this equipment must be familiar with the risks and hazards associated with it.
- 2.2.2 NEVER touch the engine or muffler while the engine is on or immediately after it has been turned off. These areas get hot and may cause burns.
- 2.2.3 NEVER use accessories or attachments that are not recommended by Wacker. Damage to equipment and injury to the user may result.
- 2.2.4 NEVER operate the machine with the belt guard missing. Exposed drive belt and pulleys create potentially dangerous hazards that can cause serious injuries.
- 2.2.5 NEVER leave machine running unattended.
- 2.2.6 ALWAYS be sure operator is familiar with proper safety precautions and operation techniques before using machine.
- 2.2.7 ALWAYS wear protective clothing appropriate to the job site when operating equipment.
- 2.2.8 ALWAYS wear hearing protection when operating equipment.
- 2.2.9 ALWAYS close fuel valve on engines equipped with one when machine is not being operated.
- 2.2.10 ALWAYS store equipment properly when it is not being used. Equipment should be stored in a clean, dry location out of the reach of children.
- 2.2.11 ALWAYS operate machine with all safety devices and guards in place and in working order. DO NOT modify or defeat safety devices. DO NOT operate machine if any safety devices or guards are missing or inoperative.
- 2.2.12 ALWAYS read, understand, and follow procedures in Operator's Manual before attempting to operate equipment.

2.3 Operator Safety while using Internal Combustion Engines



DANGER

Internal combustion engines present special hazards during operation and fueling! Read and follow warning instructions in engine owner's manual and safety guidelines below. Failure to follow warnings and safety guidelines could result in severe injury or death.

- 2.3.1 DO NOT run machine indoors or in an enclosed area such as a deep trench unless adequate ventilation, through such items as exhaust fans or hoses, is provided. Exhaust gas from the engine contains poisonous carbon monoxide gas; exposure to carbon monoxide can cause loss of consciousness and may lead to death.
- 2.3.2 DO NOT smoke while operating machine.
- 2.3.3 DO NOT smoke when refueling engine.
- 2.3.4 DO NOT refuel hot or running engine.
- 2.3.5 DO NOT refuel engine near open flame.
- 2.3.6 DO NOT spill fuel when refueling engine.
- 2.3.7 DO NOT run engine near open flames.
- 2.3.8 ALWAYS refill fuel tank in well-ventilated area.
- 2.3.9 ALWAYS replace fuel tank cap after refueling.
- 2.3.10 ALWAYS check fuel lines and fuel tank for leaks and cracks before starting engine. Do not run machine if fuel leaks are present or fuel lines are loose.

2.4 Service Safety

**WARNING**

Poorly maintained equipment can become a safety hazard! In order for the equipment to operate safely and properly over a long period of time, periodic maintenance and occasional repairs are necessary.





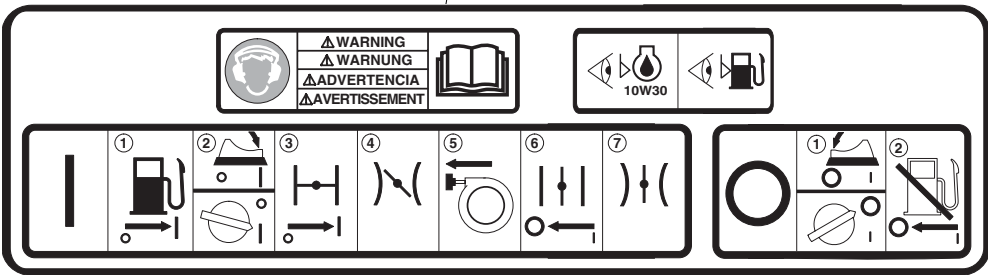

- 2.4.1 DO NOT attempt to clean or service machine while it is running. Rotating parts can cause severe injury.
- 2.4.2 DO NOT crank a flooded engine with the spark plug removed on gasoline-powered engines. Fuel trapped in the cylinder will squirt out the spark plug opening.
- 2.4.3 DO NOT test for spark on gasoline-powered engines, if engine is flooded or the smell of gasoline is present. A stray spark could ignite fumes.
- 2.4.4 DO NOT use gasoline or other types of fuels or flammable solvents to clean parts, especially in enclosed areas. Fumes from fuels and solvents can become explosive.
- 2.4.5 ALWAYS keep area around muffler free of debris such as leaves, paper, cartons, etc. A hot muffler could ignite them, starting a fire.
- 2.4.6 ALWAYS replace worn or damaged components with spare parts designed and recommended by Wacker.
- 2.4.7 ALWAYS disconnect spark plug on machines equipped with gasoline engines, before servicing, to avoid accidental start-up.
- 2.4.8 ALWAYS keep machine clean and labels legible. Replace all missing and hard-to-read labels. Labels provide important operating instructions and warn of dangers and hazards.



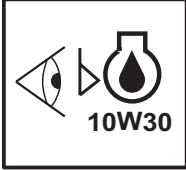

2.5 Label Locations



2.6 Warning and Informational Labels

Wacker machines use international pictorial labels where needed. These labels are described below:

Label	Meaning
	<p>To prevent hearing loss, wear hearing protection when operating this machine.</p>
	<p>Read the operator's manual for machine information.</p>
	<p>Check engine oil level. Use SAE10W30.</p>
	<p>Check fuel level.</p>
	<p>WARNING! Hot surface.</p>
	<p>Machine sound power level in dB(A).</p>

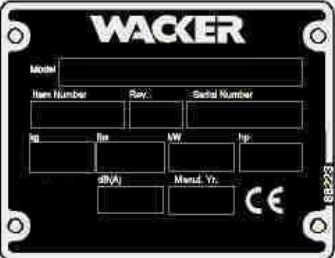

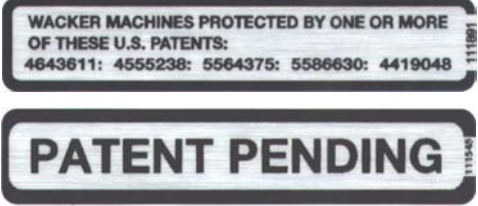
Label	Meaning
	<p>WARNING! Hand injury if caught in moving belt. Always replace belt guard.</p>
	<p>CAUTION! Read and understand the supplied operator's manual before operating this machine. Failure to do so increases the risk of injury to yourself or others.</p>
	<p>CAUTION! Lifting point</p>
	<p>DANGER! Engines emit carbon monoxide; operate only in well ventilated area. Read the operator's manual. No sparks, flames or burning objects near machine. Shut off engine before refueling.</p>
	<p>A nameplate listing the Model Number, Item Number, Revision, and Serial Number is attached to each unit. Please record the information found on this plate so it will be available should the nameplate become lost or damaged. When ordering parts or requesting service information, you will always be asked to specify the model, item number, revision number, and serial number of the unit.</p>

Label	Meaning
 <p>WACKER MACHINES PROTECTED BY ONE OR MORE OF THESE U.S. PATENTS: 4643611: 4555238: 5564375: 5586630: 4419048</p> <p>PATENT PENDING</p>	<p>This machine may be covered by one or more patents.</p>

2.7 Operating Labels

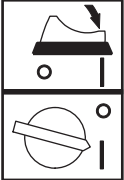
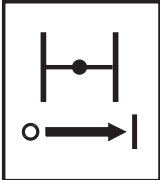
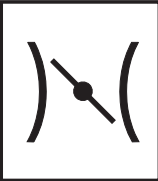
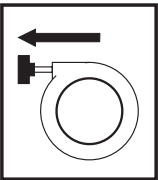
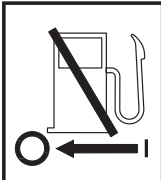
Wacker machines use international pictorial labels where needed. These labels are described below:

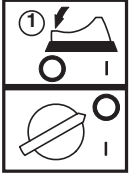
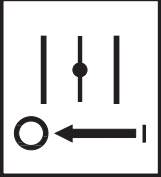
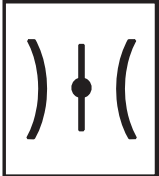
Label	Meaning
	<p>Open fuel flow valve.</p>
	<p>Push or turn engine switch to ON position.</p>
	<p>Close choke.</p>
	<p>Place throttle in the IDLE position.</p>
	<p>Pull rewind starter.</p>
	<p>Close fuel flow valve.</p>

Label	Meaning
	<p>Push or turn engine switch to OFF position.</p>
	<p>Open choke.</p>
	<p>Place throttle in the FAST position.</p>
	<p>Throttle control lever: Turtle = Idle or Slow Rabbit = Full or Fast</p>

3. Technical Data

3.1 Engine Data - Honda

		WP 1550A/AW 0007576 0007579
Engine		
Engine Make		Honda
Engine Model		GX 160 K1 QX2
Rated Power	kW (Hp)	4.1 (5.5)
Spark Plug	type	NGK BPR 6ES
Electrode Gap	mm (in.)	0.7 – 0.8 (0.028 – 0.031)
Engine Speed - full	rpm	3600 ± 100
Engine Speed - idle	rpm	1600 ± 100
Clutch Engagement	rpm	2100
Air Cleaner	type	Dual Element
Engine Lubrication	oil grade	SAE 10W30
	service class	SG or SF
Engine Oil Capacity	ml (oz.)	600 (20)
Fuel	type	Regular unleaded gasoline
Fuel Tank Capacity	l (qts.)	3.7 (3.9)
Valve Clearance (cold)	mm (in.)	Inlet: 0.15 (0.006) Outlet: 0.20 (0.008)

3.2 Plate Data

		WP 1550A/AW 0007576 0007579
Plate		
Operating Weight	kg (lbs.)	86 (190)
Water Tank Capacity	l (qts.)	10.4 (11.0)
Exciter Speed	rpm / belt	5800
Exciter Lubrication	ml (oz.)	150 (5) Automatic Transmission Fluid Dextron III / Mercon or equivalent

3.3 Sound and Vibration Specifications

The required sound specifications, per Appendix 1, Paragraph 1.7.4.f of the EC-Machine Regulations, are:

- the sound pressure level at operator’s location (L_{pA}) :
 WP1550A = 97 dB(A)
 WP1550AW = 96 dB(A)
- the sound power level (L_{WA}) = 105 dB(A)

These sound values were determined according to ISO 3744 for the sound power level (L_{WA}) and ISO 6081 for the sound pressure level (L_{pA}) at the operator’s location.

The weighted effective acceleration value, determined according to ISO 8662 Part 1, is = 6.1 m/s².

The sound and vibration specifications were obtained with the unit operating on crushed gravel at nominal engine speed.

3.4 Dimensions

mm (in.)

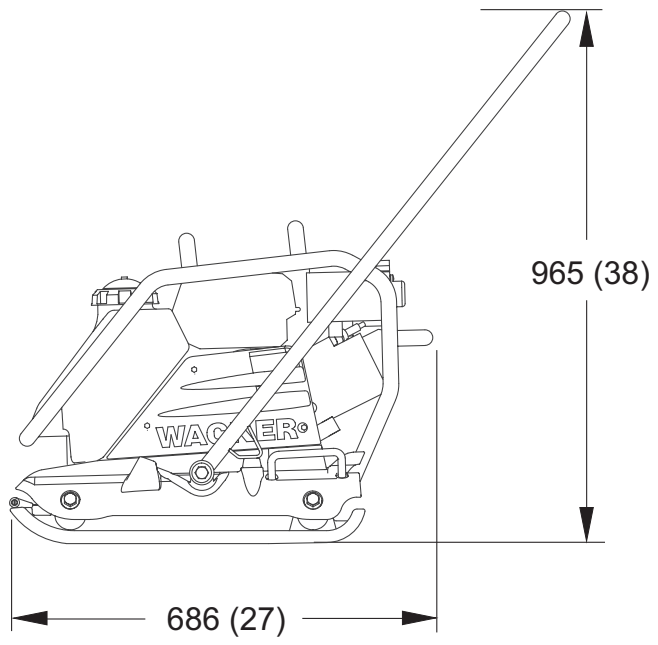
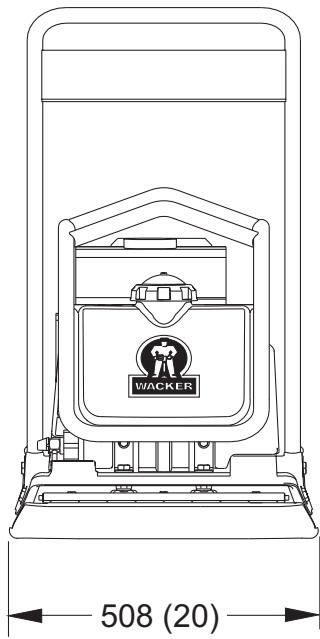

wc ar000081

4. Operation

4.1 Recommended Fuel

The engine requires regular grade unleaded gasoline. Use only fresh, clean gasoline. Gasoline containing water or dirt will damage fuel system. Consult engine owner's manual for complete fuel specifications.

4.2 Before Starting

- 4.2.1 Read and understand safety and operating instructions at beginning of this manual.
- 4.2.2 Check:
- oil level in engine.
 - fuel level.
 - condition of air cleaner.
 - tightness of external fasteners.
 - condition of fuel lines.

4.3 To Start

See Graphic: *wc_gr000014*

- 4.3.1 Open fuel valve by moving lever to the right **(a1)**.

Note: *If engine is cold, move choke lever to close position **(b1)**. If engine is hot, set choke to open position **(b2)**.*

- 4.3.2 Turn engine switch to "ON" **(e1)**.

- 4.3.3 Open throttle by moving it slightly to left **(d1)**.

- 4.3.4 Pull starter rope **(c)**.

Note: *If the oil level in the engine is low, the engine will not start. If this happens, add oil to engine. Some engines are equipped with an oil alert light **(f)** that will come on while pulling the starter rope.*

- 4.3.5 Open choke as engine warms **(b2)**.

- 4.3.6 Open throttle fully to operate.

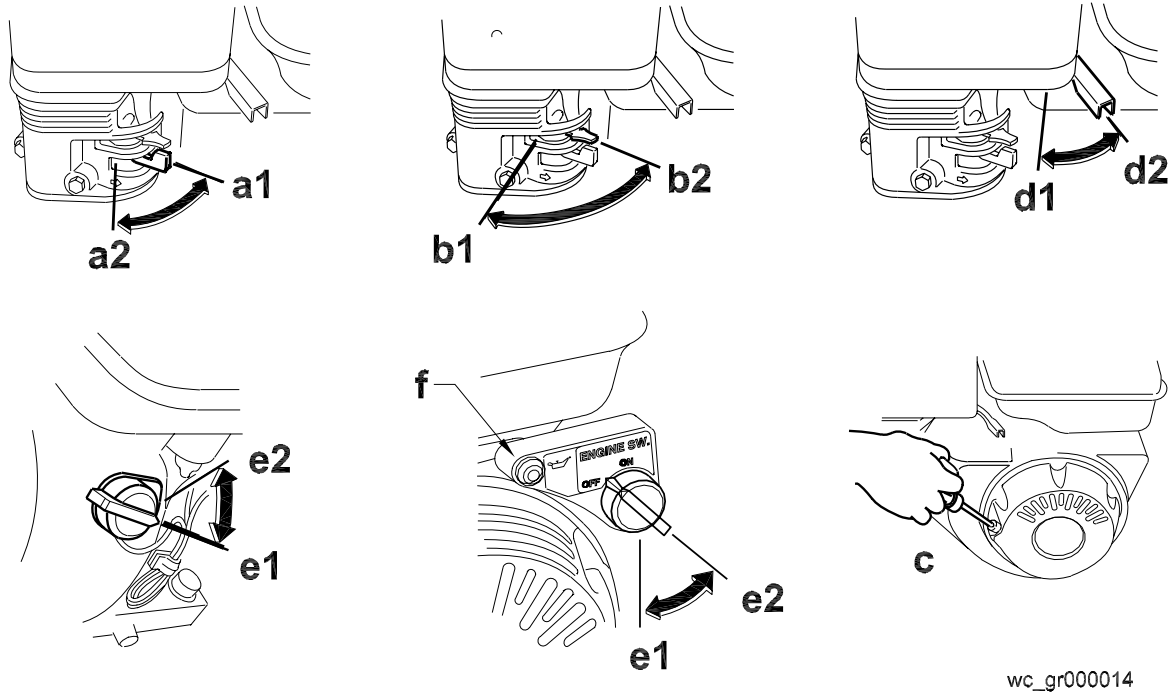

4.4 To Stop

See Graphic: *wc_gr000014*

- 4.4.1 Reduce engine RPM to idle by moving throttle completely to right (**d2**).
- 4.4.2 Turn engine switch to “OFF” (**e2**).
- 4.4.3 Close fuel valve by moving lever to the left (**a2**).

4.5 Application

This plate is designed for compacting loose, granular soils, gravel, and paving stones. It is intended to be used in confined areas and areas next to structures such as walls, curbs, and foundations. Plates equipped with water tanks can be used for compacting asphalt.

This plate is not recommended for compacting cohesive soils with a heavy clay content. For cohesive soil, use a vibratory rammer or sheepsfoot roller.

4.6 Operation

See Graphic: *wc_gr000076*

Run engine at full throttle and allow plate to pull itself along at its normal speed. When operating on an incline it may be necessary to assist plate by pushing it forward slightly. Depending on the material being compacted, three or four passes are recommended to achieve the best compaction.

While a certain amount of moisture in the soil is necessary, excessive moisture may cause soil particles to stick together and prevent good compaction. If soil is extremely wet, allow it to dry somewhat before compacting.

If soil is so dry as to create dust clouds while operating plate, some moisture should be added to the ground material to improve compaction. This will also reduce service to the air filter.

For compacting asphalt, open water tank valve **(a1)** to wet asphalt and underside of plate. This will prevent asphalt material from sticking. Two or three passes are usually sufficient to ensure good compaction.

When using plate on paving stones, attach a pad to the bottom of the plate to prevent chipping or grinding surface of the stones. A special urethane pad designed for this purpose is available as an optional accessory.

CAUTION: DO NOT operate plate on concrete or on extremely hard, dry, compacted surfaces. The plate will jump rather than vibrate and could damage both plate and engine.

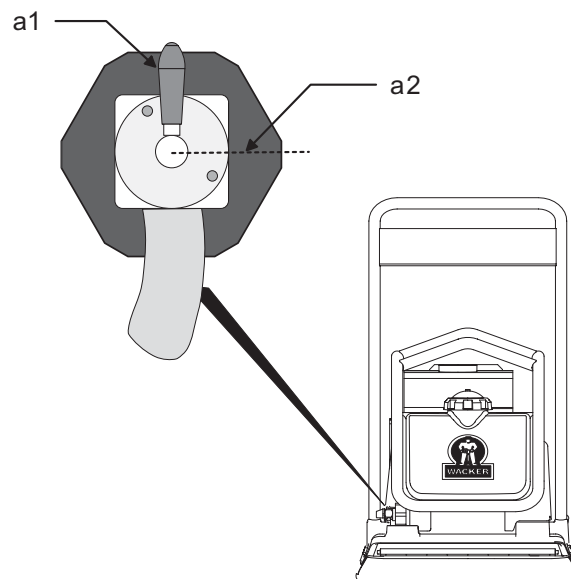

wc_gr000076

5. Maintenance

5.1 Periodic Maintenance Schedule

The chart below lists basic engine maintenance. Refer to engine manufacturer’s Operation Manual for additional information on engine maintenance.

	Daily before starting	After first 20 hrs.	Every 2 weeks or 50 hrs.	Every month or 100 hrs.	Every year or 300 hrs.
Check fuel level.	•				
Check engine oil level.	•				
Inspect fuel lines.	•				
Inspect air filter. Replace as needed.	•				
Check and tighten external hardware.	•				
Check and adjust drive belt.		•	•		
Clean air cleaner elements.			•		
Inspect shockmounts for damage.			•		
Change engine oil.		•		•	
Clean cooling system.				•	
Clean sediment cup / fuel filter.				•	
Check and clean spark plug.				•	
Check and adjust valve clearance.					•
Change exciter oil.					•

5.2 Cleaning Plate

Clean plate after use to remove dirt, stones, and mud caught under the engine console. If plate is being used in a dusty area, check engine cylinder cooling fins for heavy dirt accumulation. Keep engine cylinder fins clean to prevent engine from overheating.

5.3 Drive Belt

See Graphic: *wc_gr000077*

On new machines or after installing a new belt, check belt tension after first 20 hours of operation. Check and adjust belt every 50 hours thereafter.

To change the belt:

- 5.3.1 Remove the beltguard and remove the four hex nuts (**a**) holding pulley halves (**b**) together. Remove outer pulley half and remove belt.
- 5.3.2 Install new belt on pulley and secure pulley halves together with hex nuts. Adjust tension on belt by adding or removing spacers (**c**) between pulley halves. The fewer spacers used between pulley halves, the tighter the belt will be. Three spacers with new Wacker belts should provide the correct tension. Belt deflection should be 6–10 mm (1/4–3/8"), checked half way between the clutch pulley and the exciter pulley (**d**). Place unused spacers on outside of pulley.
- 5.3.3 Replace beltguard.

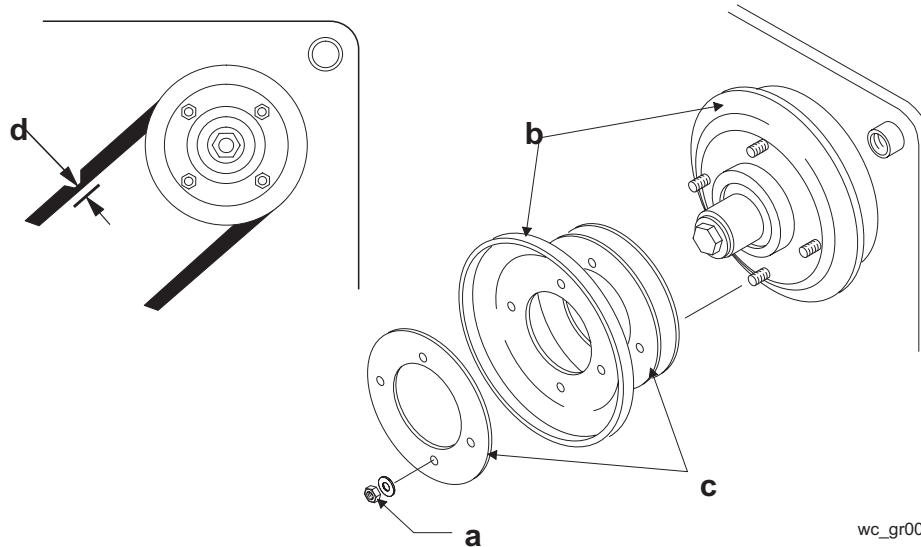

5.4 Exciter Lubrication

See Graphic: *wc_gr000078*

The exciter assembly is a self-contained, sealed unit. The bearings are lubricated using automatic transmission fluid (see *Technical Data* for type). Change fluid once every year or 300 hours of operation. When changing fluid, replace O-ring (**a**).

To change fluid:

- 5.4.1 Remove beltguard, belt, and hose from water tank.
- 5.4.2 Remove four screws (**b**) securing console assembly to baseplate and lift console assembly from baseplate.
- 5.4.3 Remove end cover (**c**) from bearing exciter assembly. Outer bearing race will remain with cover.
- 5.4.4 Tip baseplate up and drain fluid from exciter assembly. Dispose of used fluid in an appropriate manner. Contact local recycling center.
- 5.4.5 Add 150 ml (5 ounces) of automatic transmission fluid to exciter housing and fasten end cover to exciter. Do not overfill exciter or bearings may overheat.
- 5.4.6 Assemble console assembly to baseplate and install belt, beltguard, and hose to water tank.

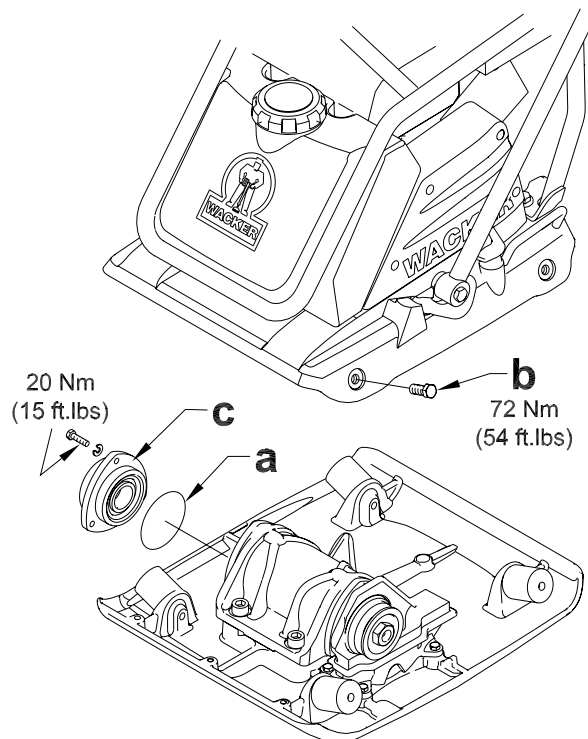

wc_gr000078

5.5 Spark Plug

See Graphic: *wc_gr000028*

Clean or replace spark plug as needed to ensure proper operation. Refer to the engine Owner's Manual.



WARNING

The muffler becomes very hot during operation and remains hot for a while after stopping the engine. Do not touch the muffler while it is hot.

Note: Refer to the Technical Data for the recommended spark plug type and the electrode gap setting.

- 5.5.1 Remove spark plug and inspect it.
- 5.5.2 Replace plug if the insulator is cracked or chipped.
- 5.5.3 Clean spark plug electrodes with a wire brush.
- 5.5.4 Set the electrode gap (**a**).
- 5.5.5 Tighten spark plug securely.

CAUTION: A loose spark plug can become very hot and may cause engine damage.

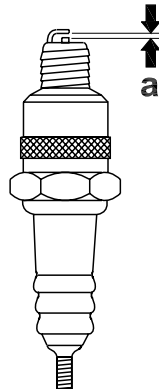

wc_gr000028

5.6 Engine Oil

See Graphic: *wc_gr000022*

5.6.1 Drain oil while the engine is still warm.

5.6.2 Remove the oil fill plug (**a**) and drain plug (**b**) to drain oil.

Note: *In the interests of environmental protection, place a plastic sheet and a container under the machine to collect any liquid which drains off. Dispose of this liquid in accordance with environmental protection legislation.*

5.6.3 Install drain plug.

5.6.4 Fill the engine crankcase with recommended oil up to the level of the plug opening (**c**). See *Technical Data* for oil quantity and type.

5.6.5 Install the oil filler plug.

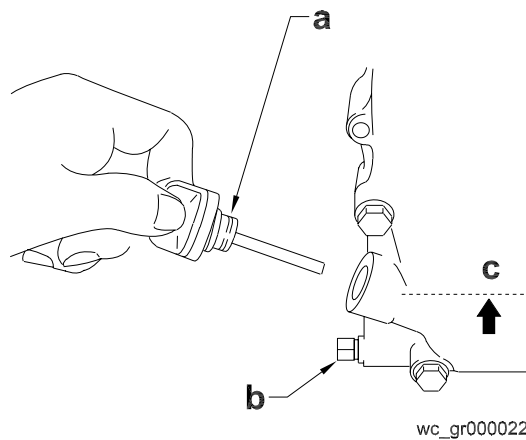

5.7 Air Cleaner

See Graphic: *wc_gr000025*

The engine is equipped with a dual element air cleaner. Service air cleaner frequently to prevent carburetor malfunction.

CAUTION: NEVER run engine without air cleaner. Severe engine damage will occur.



WARNING

NEVER use gasoline or other types of low flash point solvents for cleaning the air cleaner. A fire or explosion could result.

To service:

- 5.7.1 Remove air cleaner cover **(a)**. Remove both elements and inspect them for holes or tears. Replace damaged elements.
- 5.7.2 Wash foam element **(b)** in solution of mild detergent and warm water. Rinse thoroughly in clean water. Allow element to dry thoroughly. Soak element in clean engine oil and squeeze out excess oil.
- 5.7.3 Tap paper element **(c)** lightly to remove excess dirt. Replace paper element if it appears heavily soiled.

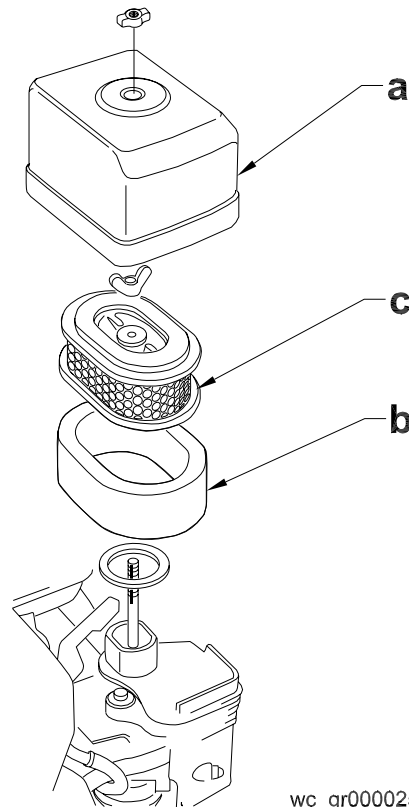

wc_gr000025

5.8 Cleaning Sediment Cup

See Graphic: *wc_gr000029*

- 5.8.1 Turn fuel valve off.
- 5.8.2 Remove sediment cup **(a)** and O-ring **(b)**.
- 5.8.3 Wash both thoroughly in a nonflammable solvent. Dry and reinstall them.
- 5.8.4 Turn fuel valve on and check for leaks.

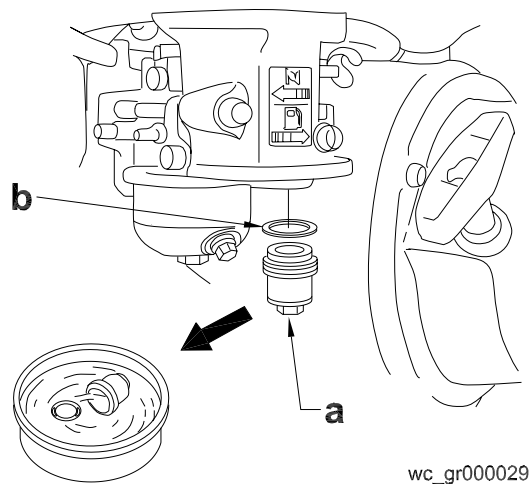

5.9 Carburetor Adjustment - Honda

See Graphic: *wc_gr000032*

- 5.9.1 Start the engine and allow it to warm up to operating temperature.
- 5.9.2 Set the pilot screw **(a)** 2 turns out. See Note.
- 5.9.3 With the engine idling, turn the pilot screw **(a)** in or out to the setting that produces the highest rpm.
- 5.9.4 After the pilot screw is adjusted, turn the throttle stop screw **(b)** to obtain the standard idle speed. See Technical Data.

Note: *On some engines the pilot screw is fitted with a limiter cap (c) to prevent excessive enrichment of the air-fuel mixture in order to comply with emission regulations. The mixture is set at the factory and no adjustment should be necessary. Do not attempt to remove the limiter cap. The limiter cap cannot be removed without breaking the pilot screw.*

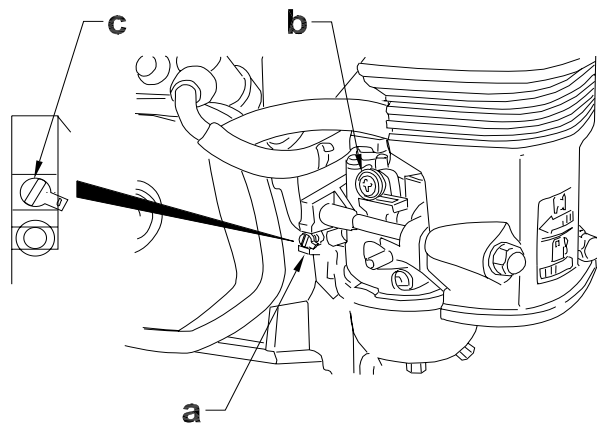

wc_gr000032

5.10 Troubleshooting

Problem / Symptom	Reason / Remedy
Plate does not develop full speed. Poor compaction.	<ul style="list-style-type: none"> • Engine throttle control not completely open. • Throttle control not adjusted correctly. • Ground too wet, plate sticking. Allow soil to dry before compacting. • Drive belt loose or worn, slipping on pulleys. Adjust or replace belt. Check that engine mounting bolts are tight. • Exciter bearings binding. Check condition and level of oil in exciter. Add or change oil. • Air filter clogged with dust, reducing engine performance. Clean or replace air filter. • Engine speed too low. Check engine speed with tachometer. Adjust or repair engine to run at correct speed. Refer to engine manual.
Engine running, no vibration	<ul style="list-style-type: none"> • Engine throttle not open. • Drive belt loose or broken. Adjust or replace. • Clutch damaged. Inspect and replace clutch. • Engine speed too low. Check engine speed. • Too much oil in exciter. Adjust oil to correct level.
Plate jumps or compacts unevenly.	<ul style="list-style-type: none"> • Ground surface too hard. • Shockmounts loose or damaged.

5.11 Storage

If plate is being stored for more than 30 days:

- 5.11.1 Remove loose stones and dirt from plate.
- 5.11.2 Clean engine cylinder cooling fins.
- 5.11.3 Clean or replace air filter.
- 5.11.4 Change engine oil and follow procedures described in engine manual for engine storage.
- 5.11.5 Cover plate and engine and store in a clean, dry area.

5.12 Lifting Machine

See Graphic: *wc_gr000079*

See *Technical Data* for the weight of the machine.

To lift machine manually:

- 5.12.1 Stop the engine.
- 5.12.2 Obtain help from a partner and plan the lift.
- 5.12.3 Grasp the machine by its cage **(a)** and lifting handle **(b)**.
- 5.12.4 Lift the machine as shown.



WARNING

To reduce risk of back injury while lifting, keep your feet flat on ground and shoulder width apart. Keep your head up and back straight.

To lift machine mechanically:

CAUTION: Before attempting to lift, be sure that all lifting devices can safely handle the weight of the machine. See *Technical Data* for the weight of the machine.

- 5.12.5 Attach hook, harness, or cable to the machine as shown and lift as desired.

CAUTION: DO NOT lift the vibroplate by its guide handle. The vibroplate can shift, causing it to fall.

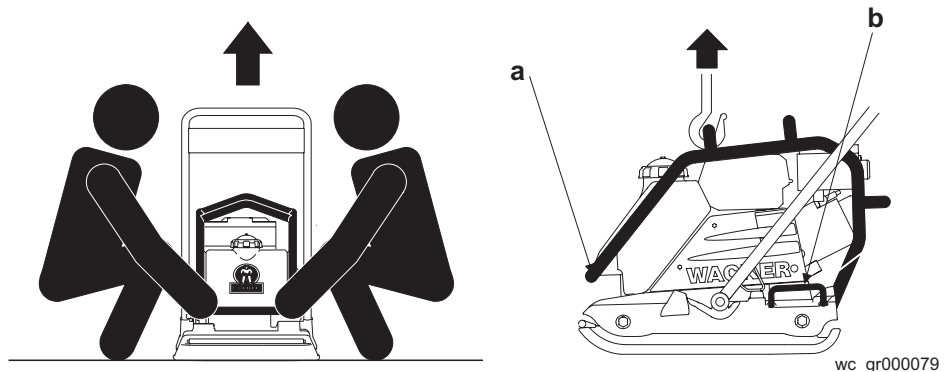

wc ar000079

5.13 Transporting Machine

See Graphic: *wc_gr000277*



To avoid burns or fire hazards, let engine cool before transporting machine or storing indoors.

WARNING

- 5.13.1 Turn fuel valve to the off position and keep the engine level to prevent fuel from spilling.
- 5.13.2 Tie down machine on vehicle to prevent machine from sliding or tipping over. Tie machine to vehicle at points shown on graphic.

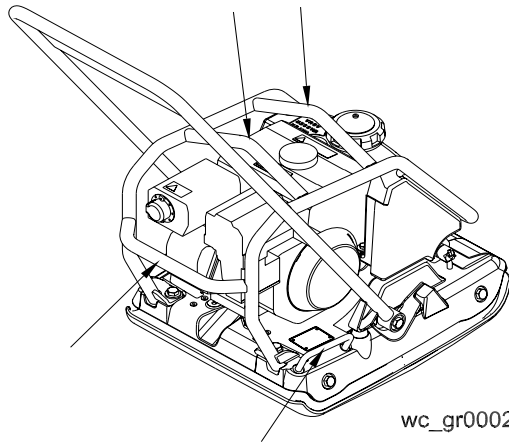

wc_gr000277

**EC - CONFORMITY CERTIFICATE
EG-KONFORMITÄTSERKLÄRUNG
CE-CERTIFICADO DE CONFORMIDAD
CERTIFICAT DE CONFORMITÉ DE LA CEE**

WACKER CORPORATION, N92 W15000 Anthony Avenue, MENOMONEE FALLS, WISCONSIN USA

hereby certifies that the construction equipment specified hereunder:
bescheinigt, daß das Baugerät:
certifica que la máquina de construcción:
atteste que le matériel:

1. Category / Art / Categoría / Catégorie

**Vibroplate
Vibrationsplatte
Plancha Vibradora
Patin Vibrant**

2. Type - Typ - Tipo - Type

**WP 1550AW
WP 1550A**

3. Item number of equipment / Gerätetypnummer /

Número de referencia de la máquina / Numéro de référence du matériel :

0007576, 0007579

4. Net installed power / absolute installierte Leistung /
Potencia instalada neta / Puissance installée nette:

4,1 kW

Has been sound tested per Directive 2000/14/EC / in Übereinstimmung mit Richtlinie 2000/14/EG bewertet worden ist /
Ha sido ensayado en conformidad con la norma 2000/14/CE / a été mis à l'épreuve conforme aux dispositions de la directive
2000/14/CEE :

Conformity Assessment Procedure Konformitätsbewertungsverfahren Procedimiento para ensayar conformidad / Procédé pour l'épreuve de conformité	Name and address of notified body / Bei folgender einbezogener Prüfstelle / Oficina matriculadora / Organisme agréé	Measured sound power level / Gemessener Schall- leistungspegel / Nivel de potencia acústica determinado / Niveau de puissance acoustique fixé	Guaranteed sound power level/ Garantierter Schalleistungs- pegel / Nivel de potencia acústica garantizado / Niveau de puissance acoustique garanti
Annex VIII	BSI, 389 Chiswick High Road London W4 4AL United Kingdom	104 dB(A)	105 dB(A)

and has been produced in accordance with the following standards:
und in Übereinstimmung mit folgenden Richtlinien hergestellt worden ist:
y ha sido fabricado en conformidad con las siguientes normas:
et a été produit conforme aux dispositions des directives européennes ci-après :

**2000/14/EC
EMC 89/336/EEC
EN 50082-1
VDE 0879-1
98/37/EEC
EN 500-1
EN 500-4**

William Lahner

Greg Orzal

29.10.01

Date / Datum / Fecha / Date

WACKER CORPORATION



UNITED KINGDOM

LONDON

Washington
Warrington
Worksop
Redditch
Pontypool
Ashford
Exeter
Hungerford
Lanarks

LEA ROAD
WALTHAM CROSS, HERTS EN9 1AW

Washington/Tyne N37 1LH
Winwick Quay, Warrington WA2 8RE
Worksop S81 7BE
Washford, Redditch B98 0DQ
Pontypool, Gwent NP4 6PD
Ashford, Kent TN23 2NF
Clyst, Honiton, Exeter EX5 2LG
Hungerford R617 OYX
Bellshill, Lanarks ML4 3NN

Tel. (44)(01992) 707200

Tel. (0191) 4 16 63 92
Tel. (01925) 57 39 55
Tel. (01909) 48 45 06
Tel. (01527) 2 45 56
Tel. (01495) 75 05 95
Tel. (01233) 64 52 27
Tel. (01392) 6 97 71
Tel. (01488) 68 14 28
Tel. (01698) 84 58 15

ÖSTERREICH

1110 WIEN
4050 Traun
9020 Klagenfurt
8054 Graz-Strassgang
6122 Fritzens
5300 Hallwang b. Sbg.
3106 St. Pölten

SCHEMMERLSTR.82
Wiener Bundesstr. 147
Wiegelegasse 18
Kärntner Str. 512
Innstr. 11
Wiener Bundesstr. 17
Hnilickastr. 9

Tel. (43) 01-7671515

Tel. 07229-73739
Tel. 0463-262716
Tel. 0316-281690
Tel. 05224-51351
Tel. 0662-661741
Tel. 02742-73170

DEUTSCHLAND

80809 MÜNCHEN

PREUSSENSTR. 41
Fax 089/35 40 23 90

Tel. 089/35 40 21

85757 Karlsfeld (WLZ)
21109 Hamburg
24145 Kiel
23566 Lübeck
28307 Bremen-Mahndorf
26789 Leer-Bingum
30165 Hannover
38112 Braunschweig
34233 Fulda
40721 Hilden
41065 Mönchengladbach
46485 Wesel
45326 Essen
48291 Telgte
49565 Bramsche
44319 Dortmund
33659 Bielefeld
52355 Düren
53842 Troisdorf
56218 Mülheim-Kärlich
57080 Siegen
60388 Frankfurt
35398 Gießen
55129 Mainz-Hechtsheim
66119 Saarbrücken
67133 Maxdorf
74172 Neckarsulm-Obereisesheim
71254 Ditzingen
72336 Balingen-Frommern
76327 Pfinztal
77746 Schutterwald
78315 Radolfzell
79112 Freiburg-Opfingen
89155 Erbach
88353 Kißlegg-Zaisenhofen
85716 Unterschleißheim
85077 Manching
82538 Geretsried
83064 Raubling
94491 Hengersberg
93128 Regenstauf
90765 Fürth-Stadeln
95326 Kulmbach
97080 Würzburg
63741 Aschaffenburg
86167 Augsburg

Fax 040/75 73 90
Fax 0431/71 46 25
Fax 0451/62 56 15
Fax 0421/48 15 36
Fax 0491/6 25 39
Fax 0511/3 52 49 69
Fax 0531/31 29 24
Fax 0561/81 10 58
Fax 02103/4 69 31
Fax 02161/4 25 44
Fax 0281/5 16 37
Fax 0201/32 13 02
Fax 02504/71 47
Fax 05461/49 22
Fax 0231/21 82 27
Fax 0521/40 31 14
Fax 02421/6 21 22
Fax 02241/4 65 75
Fax 0261/2 65 55
Fax 0271/31 10 49
Fax 069/41 71 89
Fax 0641/2 98 19
Fax 06131/50 79 80
Fax 0681/85 15 30
Fax 06237/50 08
Fax 07132/4 36 19
Fax 07156/1 82 04
Fax 07433/3 76 86
Fax 0721/46 86 60
Fax 0781/5 97 13
Fax 07732/5 65 08
Fax 07664/5 97 76
Fax 07305/86 10
Fax 07563/85 73
Fax 089/3 17 13 07
Fax 08459/76 02
Fax 08171/3 14 09
Fax 08035/39 79
Fax 09901/32 13
Fax 09402/33 66
Fax 0911/76 34 90
Fax 09221/8 44 87
Fax 0931/9 81 58
Fax 06021/8 36 17
Fax 0821/70 78 58

Tel. 018131-59780
Tel. 040/75 15 66
Tel. 0431/71 15 25
Tel. 0451/62 56 19
Tel. 0421/48 15 01
Tel. 0491/6 72 20
Tel. 0511/3 52 40 61
Tel. 0531/31 21 80
Tel. 0561/81 10 59
Tel. 02103/3 10 48
Tel. 02161/48 11 41
Tel. 0281/8 98 79
Tel. 0201/31 17 93
Tel. 02504/26 68
Tel. 05461/6 21 21
Tel. 0231/21 82 26
Tel. 0521/4 07 77
Tel. 02421/6 30 51
Tel. 02241/4 40 31
Tel. 0261/2 65 10
Tel. 0271/31 50 55
Tel. 069/42 40 80
Tel. 0641/2 22 69
Tel. 06131/59 20 70
Tel. 0681/85 20 11
Tel. 06237/72 00
Tel. 07132/4 36 18
Tel. 07156/60 54
Tel. 07433/47 53
Tel. 0721/46 04 67
Tel. 0781/5 23 43
Tel. 07732/5 64 85
Tel. 07664/10 14
Tel. 07305/61 22
Tel. 07563/82 76
Tel. 089/3 10 60 31
Tel. 08459/69 97
Tel. 08171/3 12 68
Tel. 08035/22 22
Tel. 09901/21 99
Tel. 09402/45 01
Tel. 0911/76 40 24
Tel. 09221/26 20
Tel. 0931/9 17 08
Tel. 06021/8 36 16
Tel. 0821/70 22 07

13627 Berlin
13627 Berlin-Nord (Land-Brandenburg)
14974 Genshagen (Berlin-Süd)
19061 Schwerin/Görries
01097 Dresden
04430 Blenitz/OT Dölzig (Leipzig)
99428 Nohra (Erfurt)
09247 Röhrsdorf (Chemnitz)
39167 Irxleben (Magdeburg)
17033 Neubrandenburg

Fax 030/349 919-12
Fax 030/344 13 52
Fax 03378/81 06 23
Fax 0385/660 513
Fax 0351/803 60 91
Fax 034205/5 89 83
Fax 03643/82 58 28
Fax 03722/50 24 85
Fax 039204/6 64 78
Fax 0395/369 00 41

Tel. 030/349 919-0
Tel. 030/344 30 47
Tel. 03378/81 06 21
Tel. 0385/650 55
Tel. 0351/8036090
Tel. 034205/58982
Tel. 03643/825826
Tel. 03722/502 484
Tel. 039204/56 78
Tel. 0395/3690040

UNITED STATES

CORPORATE OFFICE
 MENOMONEE FALLS, WI 53052 N92 W15000 ANTHONY AVE. **Tel. (262) 255-0500**

CANADA

MISSISSAUGA, ONT. L5T 2N6 160 ADMIRAL BLVD. **Tel. (905) 795-1661**
 Calgary, Alta. T2H 2H9 #11, 6115-4 St. S.E. **Tel. (403) 255-3336**
 St. Laurent, Quebec H4R 2C1 3526 Rue Ashby **Tel. (514) 337-1708**

MEXICO

MEXICO CITY 2A. CERRADA NORTE 147 NO. 20 **Tel. (55) 53-53-15-03**
 COL. SAN MIGUEL AMANTLA 02700 Mexico D.F.
 Monterrey, Nuevo León Calle Nardo #970, Col. Cementos, C. P. 64520 **Tel. (81) 83-31-12-85**
 C. P. 45010, Zapopan, Jalisco Periférico Poniente No. 2100-Int. F, **Tel. (33) 36271499**
 Col. Lomas del Colli
 C. P. 37530 León, Guanajuato Privada Manzanares #103, Fracc.San Isidro de Jerez **Tel. (477)7-11-34-35**
 C. P. 91700 Veracruz, Ver. Miguel Alemán N°. 1001B, Col. Centro **Tel. (229)9-35-10-44**

ARGENTINA

BUENOS AIRES 1611 Colectora Oeste de Ruta Panamerica **Tel. 5411-4-748-6800**
 Km 28.5 Don Torcuato

BRASIL

SÃO PAULO Avda. Arquimedes 1070 **Tel. 5511-4582-4333**
 Unidade Autonoma No. 6
 Jundiaí, São Paulo

CHILE

SANTIAGO El Rosal 5000, Huechuraba, Casilla 130 - Correo 30 **Tel. (56) 2-7400014**
 Antofagasta Orella 975 **Tel. (56) 55-227250**
 Temuco Balmaceda 298 **Tel. (56) 45-214425**

AUSTRALIA

CLAYTON, VIC. 3169 PO Box 1315 RMDC **Tel. (61) 03-95474033**
 Norwood, S.A. 5067 45 Beulah Road **Tel. 08-3622331**
 Woodridge, QLD 4114 Unit 2, 6-8 Pendrey Court **Tel. 07-32089577**
 Osborne Park, W.A. 6017 Unit P, 69-73 Hector Street **Tel. 09-4452911**
 Auburn, N.S.W. 2144 14 Vore Street **Tel. 02-7480366**

JAPAN

OHTA-KU, TOYKO 144 2-CHOME 18-1, MINAMI-KAMATA **Tel. (81) 03-37329281/5**
 Hirano-ku, Osaka-shi Miyake Nishi, 4-Chome **Tel. 0723 30-0571**
 Sendai-shi Tachimachi 1-7-21 **Tel. 022 284-8032**
 Fukuoka-shi Sannoh 1-7-1, Hakata-ku **Tel. 092 451-1083**

MALAYSIA

46150 PETALING JAYA 5. JALAN PJS 11/22 **Tel. (03) 7364770**
 Selangor Darul Ehsan Bandar Sunway

NEW ZEALAND

WIRI-AUCKLAND 4A Ponui Place **Tel. (64) (9) 270 3784**
 Mt. Wellington, Auckland

SINGAPORE

JURONG TOWN SINGAPORE 2263 NO. 23, Tuas Ave. 18 **Tel. (65) 861-0446**

THAILAND

BANGKOK 10250 22/197 Pattanakarn Rd. **Tel. (66) 2-319-9363/65**
 Soi Mooban Panya

SOUTH AFRICA

JOHANNESBURG 1031 KATROL AVE., ROBERTVILLE X10 **Tel. H/O Jhb(011) 672-0847**
 Durban Roodepoort / P.O. Box 2163, Florida 1710, Gauteng. **Tel. Dbn(031) 702-3337**
 Capetown 10 Kinsman Rd. P.O. Box 420, New Germany 3620 **Tel. Cpt(021) 981-2197**
 Cor. Beatrix & Carel, Marincowitz St. **Tel. Cpt(021) 981-2197**
 P.O. Box 398, Brackenfell 7560

CHINA

HONG KONG Unit 611-612, 6/F Sunley Centre **Tel. (852) 24068613**
 9 Wing Yin Street
 Kwai Chung, New Territories

